

COPYRIGHT © 2020 PASCUAL, PEREZ, KILIDDJIAN & ASSOCIATES - ARCHITECTS - PLANNERS
The architectural design and detail drawings for this building and / or overall project are the legal property of and all rights reserved by the Architect. Their use for reproduction, construction or distribution is prohibited unless authorized in writing by Architect.

Received after DRC Meeting
to address DRC comments
prior to the submission of a
Building Permit Application.

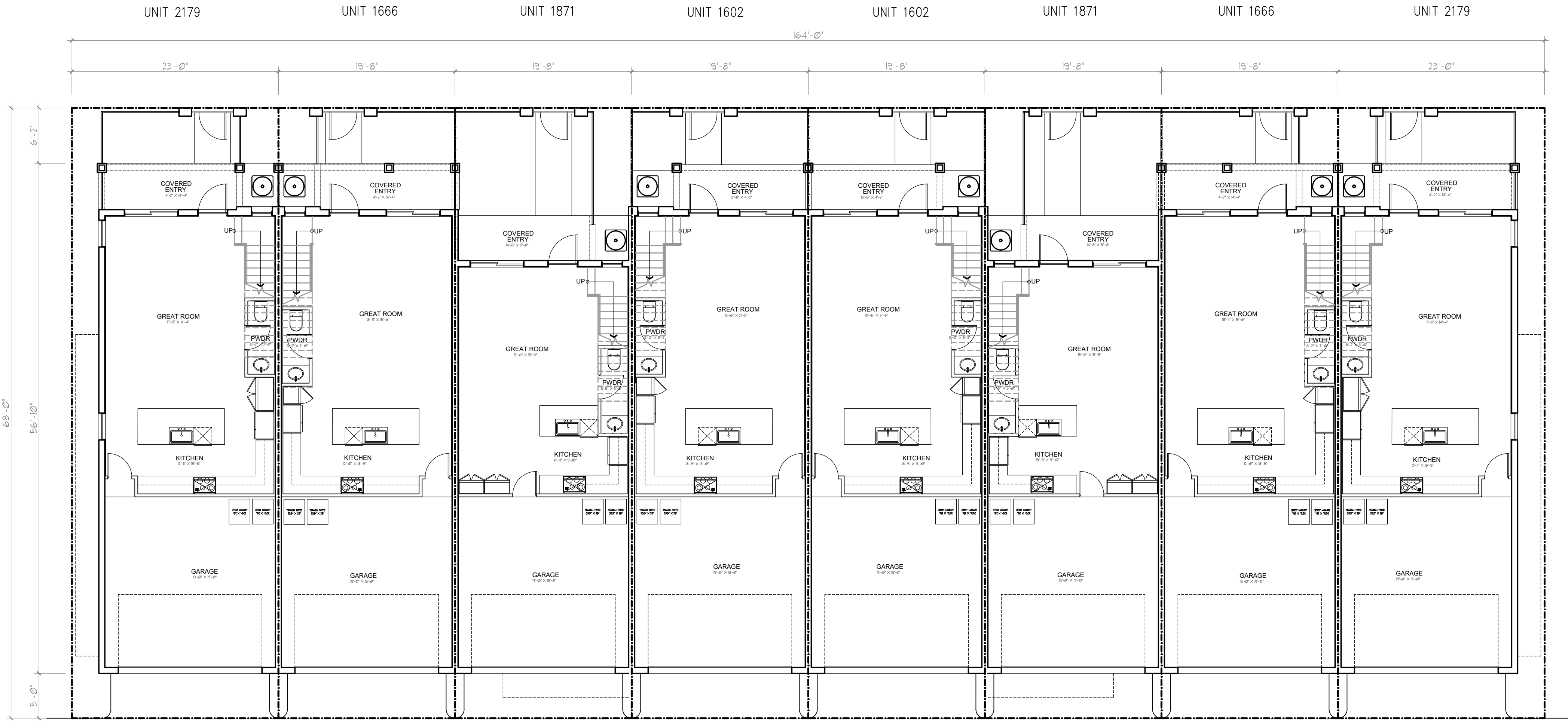

8 UNITS BUILDING LINEAR - FIRST FLOOR PLAN

SCALE: 1/8" = 1'-0"

8 UNIT BREAKDOWN					
UNIT TYPE	BEDROOMS / BATHS	UNIT AREA A/C	UNIT AREA GROSS (garage, cov. entry & cov. terrace)	TOTAL No UNIT TYPES	TOTAL A/C AREA PER UNIT TYPE
UNIT 1602	3 / 3.5	1,602 SF	2,143 SF	2	3,204 SF
UNIT 1666	4 / 2.5	1,666 SF	2,163 SF	2	3,332 SF
UNIT 1871-SKYDECK	3 / 3.5	1,871 SF	2,878 SF	2	3,742 SF
UNIT 2179-SKYDECK	4 / 3.5	2,179 SF	3,311 SF	2	4,358 SF
TOTAL BUILDING				8	14,636 SF

OCCUPANCY CLASSIFICATION:
RESIDENTIAL - GROUP R-3

CONSTRUCTION TYPE:
TYPE V-B

NUMBER OF FLOORS:
3 STORIES MAX

HEIGHT OF BUILDING TO HIGHEST OCCUPIABLE FLOOR LEVEL:
21' - 8"

GENERAL NOTES:
-A/C STAND MOUNTING HEIGHTS SHALL COMPLY WITH FBC 2023 TABLE 1322.3
-INDOOR RADIO PROPAGATION SIGNAL STRENGTH MODEL TO COMPLY WITH NFPA 72 CHAPTER 24, FBC BROWARD COUNTY AMENDMENTS CHAPTER 1, SECTION 118

PASCUAL
PEREZ
KILIDDJIAN
STARR
ARCHITECTS - PLANNERS
LICENSE # AA 26001357
EDGARDO PEREZ, AIA
LICENSE No.: AR 0015394
MARIO P. PASCUAL, AIA
LICENSE No.: AR 0008254
PETER KILIDDJIAN, AIA
LICENSE No.: AR 0093067
ANDREW J. STARR, RA
LICENSE No.: AR 0095130
AT THE BEACON CENTER
1330 NW 84th AVENUE
DORAL, FLORIDA 33126
PH: (305) 592-1363
FAX: (305) 592-6865
http://www.ppkarch.com

COPYRIGHT © PASCUAL, PEREZ, KILIDDJIAN, STARR, ARCHITECTS - PLANNERS
The architectural design and detail drawings of this building and/or overall project are the legal property of, and all rights are reserved by the Architect. Their use for reproduction, construction or distribution is prohibited unless authorized in writing by the Architect.

REVISIONS:

OWNER:
LENNAR HOMES

POMPANO LIVE!
BY: LENNAR HOMES
POMPANO BEACH, FLORIDA

SEAL:

TOWNHOUSE

8 UNITS BUILDING LINEAR
FIRST FLOOR PLAN
DATE: 2024-08-23
SCALE: AS SHOWN
DRAWN: CG/JC
CHECK BY: PPKS
JOB NO.:

A-3

SHEET NO.: